

# UNOH UNIVERSITY OF NORTHWESTERN OHIO

## CAMPUS MAP

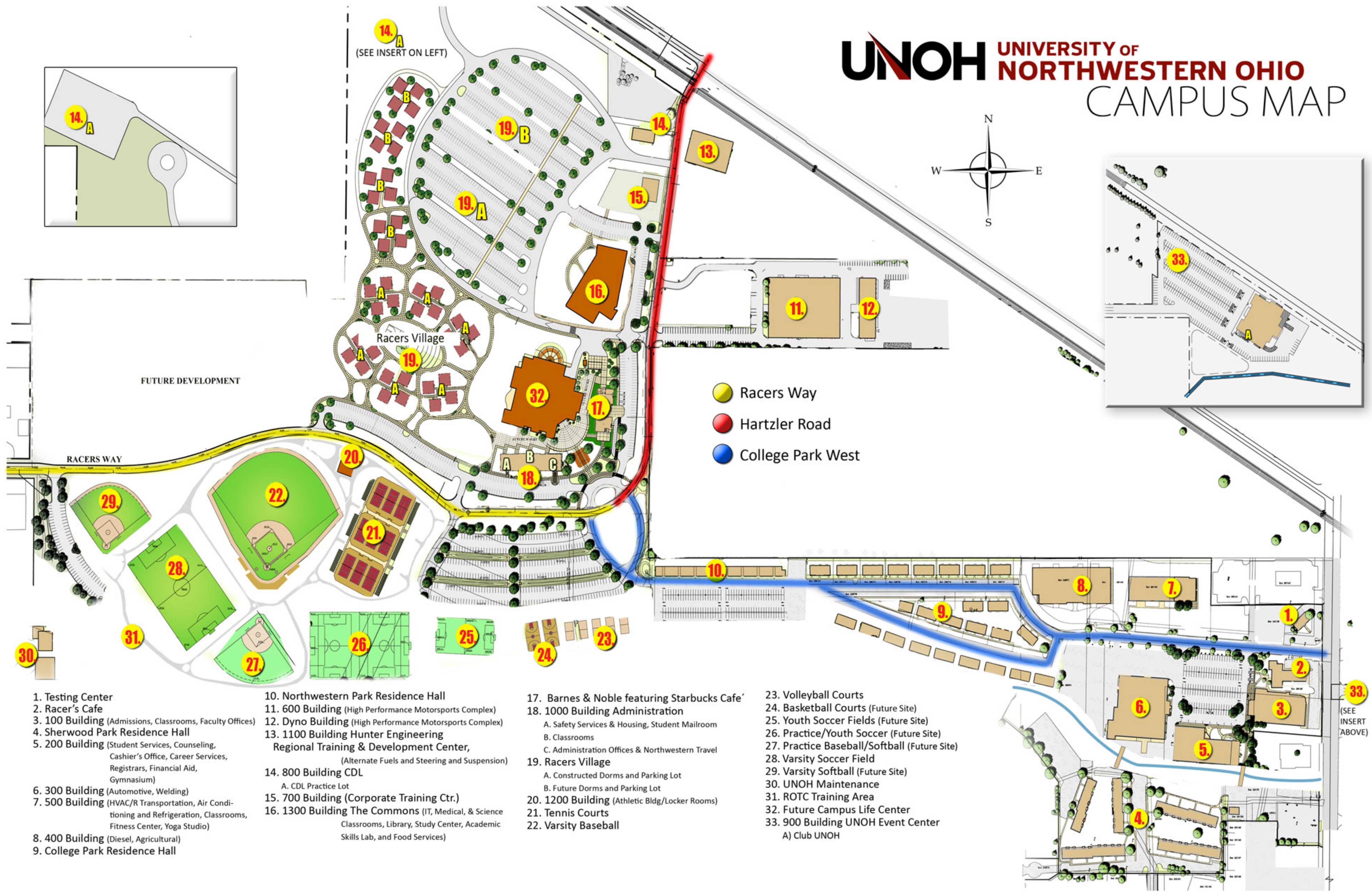
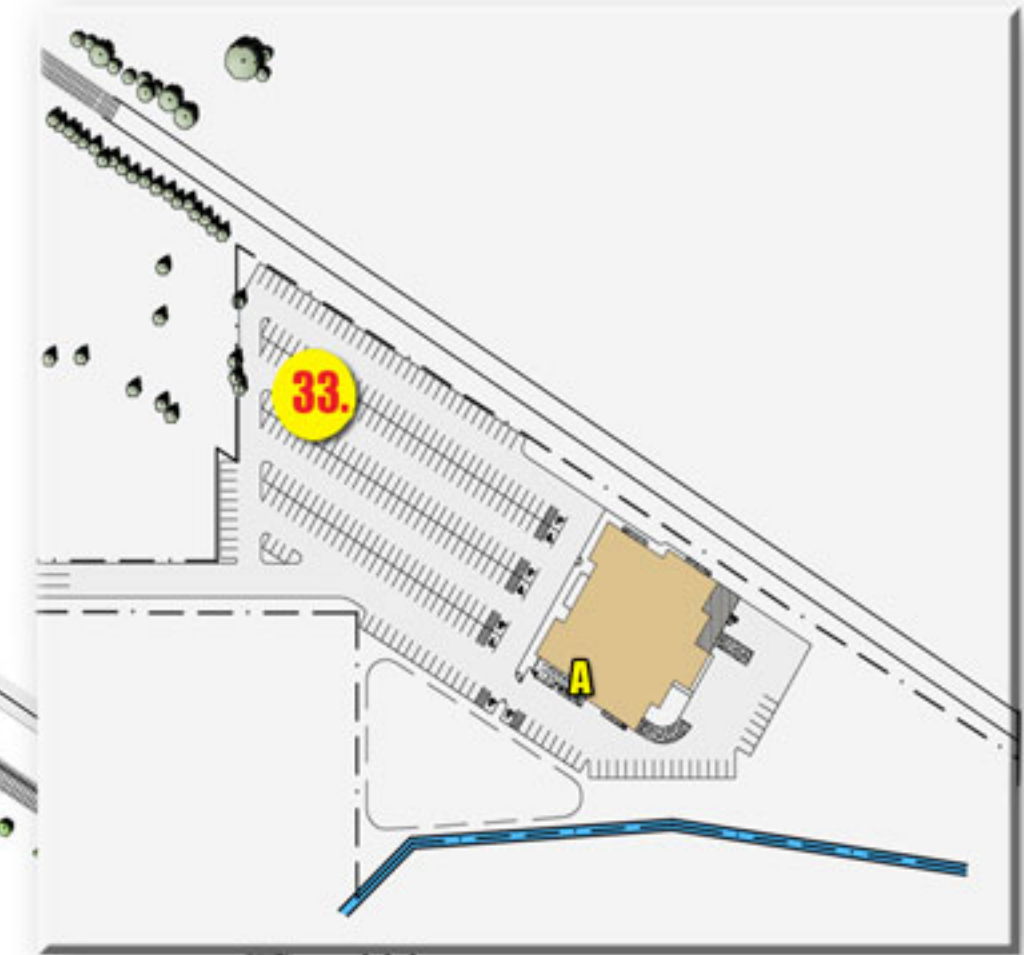
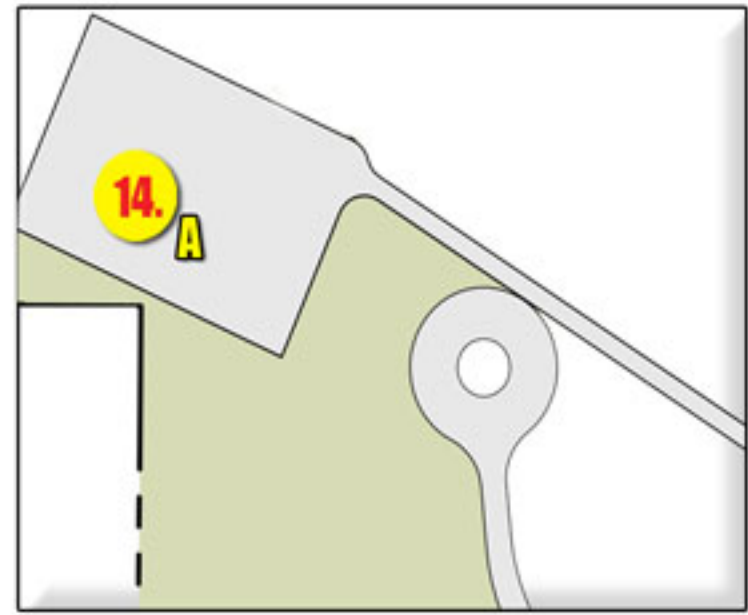
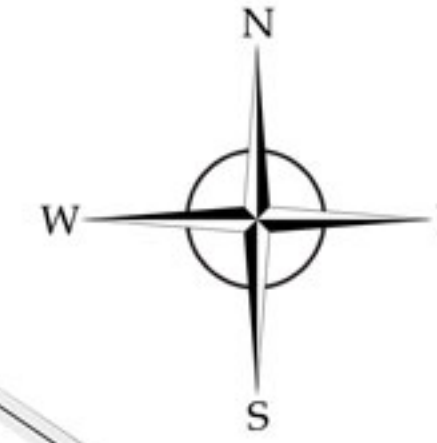

- Racers Way
- Hartzler Road
- College Park West

FUTURE DEVELOPMENT

RACERS WAY

Racers Village

- |  |  |  |   |
|--|--|--|---|
| <ul style="list-style-type: none"> <li>1. Testing Center</li> <li>2. Racer's Cafe</li> <li>3. 100 Building (Admissions, Classrooms, Faculty Offices)</li> <li>4. Sherwood Park Residence Hall</li> <li>5. 200 Building (Student Services, Counseling, Cashier's Office, Career Services, Registrars, Financial Aid, Gymnasium)</li> <li>6. 300 Building (Automotive, Welding)</li> <li>7. 500 Building (HVAC/R Transportation, Air Conditioning and Refrigeration, Classrooms, Fitness Center, Yoga Studio)</li> <li>8. 400 Building (Diesel, Agricultural)</li> <li>9. College Park Residence Hall</li> </ul> | <ul style="list-style-type: none"> <li>10. Northwestern Park Residence Hall</li> <li>11. 600 Building (High Performance Motorsports Complex)</li> <li>12. Dyno Building (High Performance Motorsports Complex)</li> <li>13. 1100 Building Hunter Engineering Regional Training &amp; Development Center, (Alternate Fuels and Steering and Suspension)</li> <li>14. 800 Building CDL                     <ul style="list-style-type: none"> <li>A. CDL Practice Lot</li> </ul> </li> <li>15. 700 Building (Corporate Training Ctr.)</li> <li>16. 1300 Building The Commons (IT, Medical, &amp; Science Classrooms, Library, Study Center, Academic Skills Lab, and Food Services)</li> </ul> | <ul style="list-style-type: none"> <li>17. Barnes &amp; Noble featuring Starbucks Cafe'</li> <li>18. 1000 Building Administration                     <ul style="list-style-type: none"> <li>A. Safety Services &amp; Housing, Student Mailroom</li> <li>B. Classrooms</li> <li>C. Administration Offices &amp; Northwestern Travel</li> </ul> </li> <li>19. Racers Village                     <ul style="list-style-type: none"> <li>A. Constructed Dorms and Parking Lot</li> <li>B. Future Dorms and Parking Lot</li> </ul> </li> <li>20. 1200 Building (Athletic Bldg/Locker Rooms)</li> <li>21. Tennis Courts</li> <li>22. Varsity Baseball</li> </ul> | <ul style="list-style-type: none"> <li>23. Volleyball Courts</li> <li>24. Basketball Courts (Future Site)</li> <li>25. Youth Soccer Fields (Future Site)</li> <li>26. Practice/Youth Soccer (Future Site)</li> <li>27. Practice Baseball/Softball (Future Site)</li> <li>28. Varsity Soccer Field</li> <li>29. Varsity Softball (Future Site)</li> <li>30. UNOH Maintenance</li> <li>31. ROTC Training Area</li> <li>32. Future Campus Life Center</li> <li>33. 900 Building UNOH Event Center                     <ul style="list-style-type: none"> <li>A) Club UNOH</li> </ul> </li> </ul> |
|--|--|--|---|

33. (SEE INSERT ABOVE)